

INSTALLATION INSTRUCTIONS

Disk Brake Kit: for Honda ATV's

Do not discard packaging until product has been successfully installed.

Modifications *must* be made when using on OEM 12" Aluminum Wheel with inner lip.

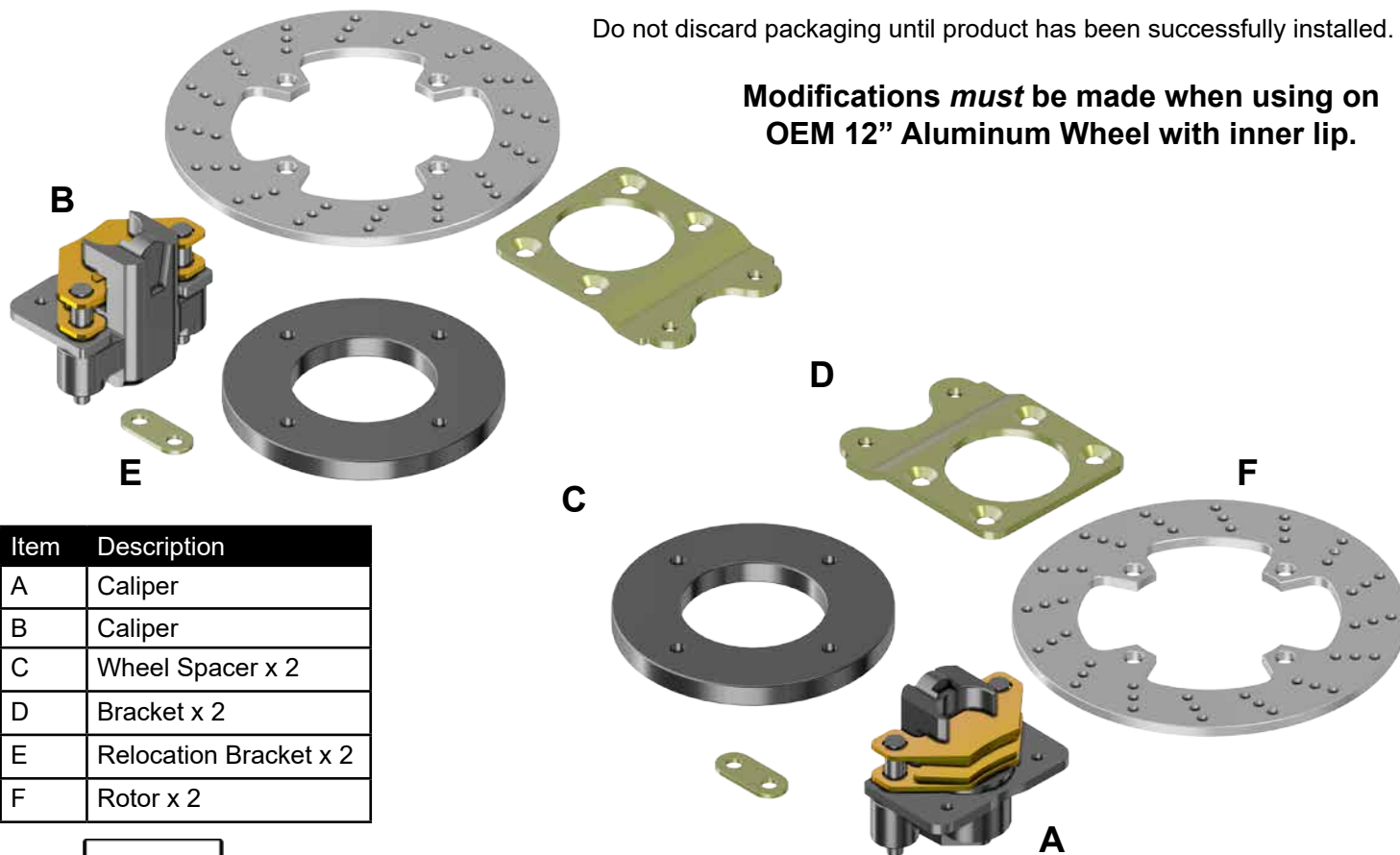

Item	Description
A	Caliper
B	Caliper
C	Wheel Spacer x 2
D	Bracket x 2
E	Relocation Bracket x 2
F	Rotor x 2

8x  Spacer

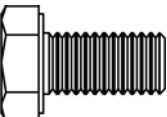
4x  M8-1.25 x 16mm Lg. HHCS

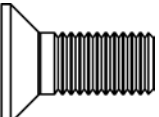
8x  M8-1.25 x 20mm Lg. FHCS

2x  M6-1.0 Nylock Nut

2x  M8 Lock Washer

2x  Cotter Pin

2x  M6-1.0 x 16mm Lg. FHCS

8x  M10-1.25 x 70mm Lg. HHCS

Need help with your installation?



sales@superatv.com



www.superatv.com



1-855-743-3427



8:00am - 9:00pm EST M-Th
8:00am - 7:00pm EST Friday
9:00am - 2:00pm EST Saturday

Read instructions and view illustrations before beginning.

*Thank You
For Choosing*

SUPERATV.COM[®]

Caliper Notes:

To use with 12" aluminum Wheels, area shown must be slightly ground to clear Inner Wheel Lip.



When installing Calipers ensure that Bleeders face UP.

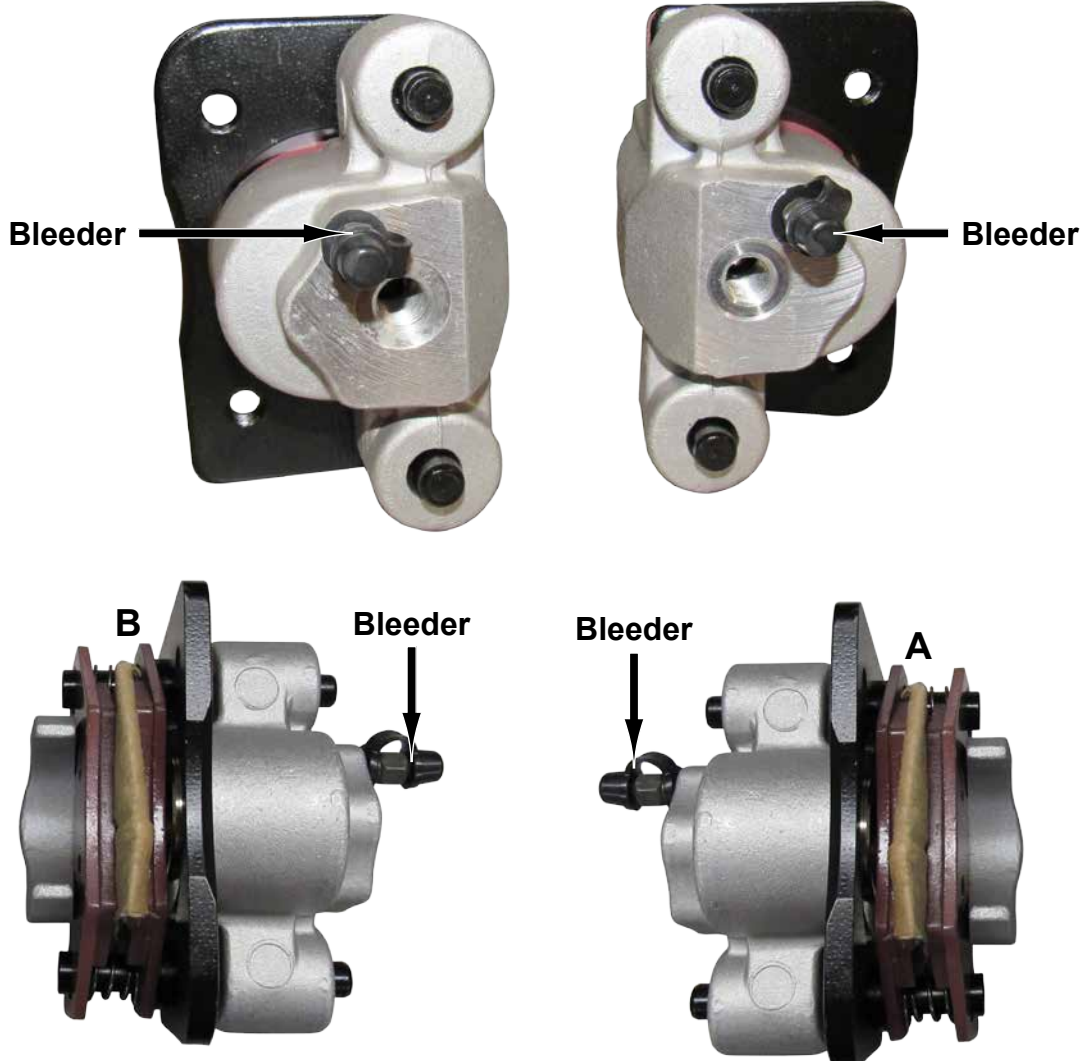

Liability Statement

SuperATV's® products are designed to best fit user's ATV/UTV under stock conditions. Adding, modifying, or fabricating any factory or aftermarket parts will void any warranty provided by SuperATV® and is not recommended. SuperATV's® products could interfere with other aftermarket accessories. If user has aftermarket products on machine, contact SuperATV® to verify that they will work together.

Although SuperATV® has thousands of satisfied customers, user should be aware that installing lift kits, long travel, or suspension kits, tires, etc. will change the ride of machine and may increase maintenance and part wear. Operating any off-road machine while, or after, consuming alcohol and/or drugs increases risk of bodily harm or death. No warranty or representation is made as to this product's ability to protect user from severe injury or death. SuperATV® urges operators and occupants to wear a helmet and appropriate riding gear at all times.

By purchasing and installing SuperATV® products, user agrees that should damages occur, SuperATV® will not be held responsible for loss of time, use, labor fees, replacement parts, or freight charges. SuperATV®, nor any 3rd party, will not be held responsible for any direct, indirect, incidental, special, or consequential damages that result from any product purchased from SuperATV®. The total liability of seller to user for all damages, losses, and causes of action, if any, shall not exceed the total purchase price paid for the product that gave rise to the claim.

SuperATV® will warranty only parts provided by SuperATV®. Any damage or problems with OEM housings, bearings, seals, or other manufacturers' products will not be covered by SuperATV®. SuperATV® parts and products are not warranted if item was not installed properly, misused, or modified.

Installing, adding, modifying, or fabricating any factory or aftermarket product to your ATV/UTV may violate certain local, state, and federal laws. Be advised that laws vary depending on town, city, county, state, etc. Use of certain products on public streets, roads, or highways may be in violation law. The Buyer is solely and exclusively legally and personally responsible for any violation of the law by the installation or use of the product. You must abide by all local, state, and federal laws, including but not limited to vehicle safety, traffic laws, and ordinances. It is your responsibility to know the laws and how they apply to you.

The Buyer is responsible to fully understand the capability and limitations of his/her vehicle according to manufacturer specifications, warnings and instructions and agrees to hold SuperATV® harmless from any damage resulting from failure to adhere to such specifications, warnings and/ or instructions. The Buyer is also responsible to obey all applicable federal, state, and local laws and ordinances when operating his/her vehicle while using this product, and the Buyer agrees to hold SuperATV® harmless from any violation thereof.

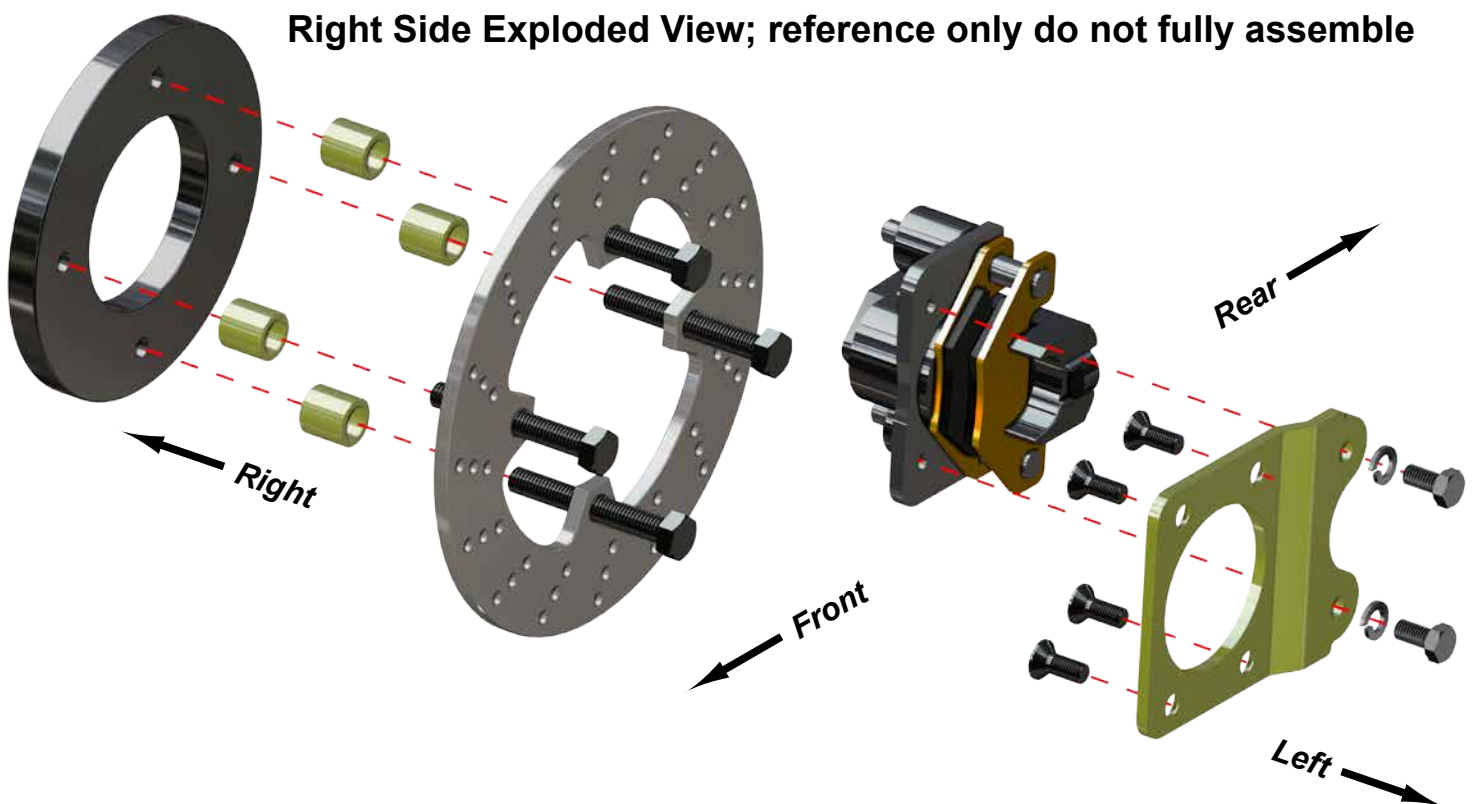

Removal: *Keep all components removed from machine.*

- Raise front of vehicle and secure on jack stands. Remove Wheels, Cotter Pin, and Castle Nut from Axle.
- Remove Brake Drum.
- Remove (2) Bolts securing Hub to Brake Drum and remove Studs from Hub. *Note: a hydraulic press is preferred but a hammer will work.*
- Remove Brake Line. Secure so that brake fluid doesn't drain.
- Remove (4) bolts securing Backing Plate to Steering Knuckle and move out of way.

- Install Bracket (D) to Knuckle with hardware shown.

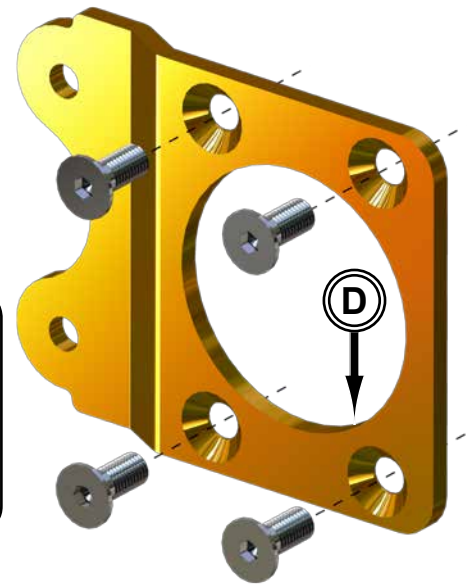
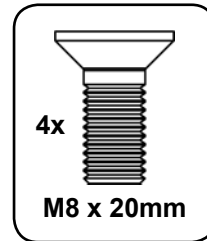
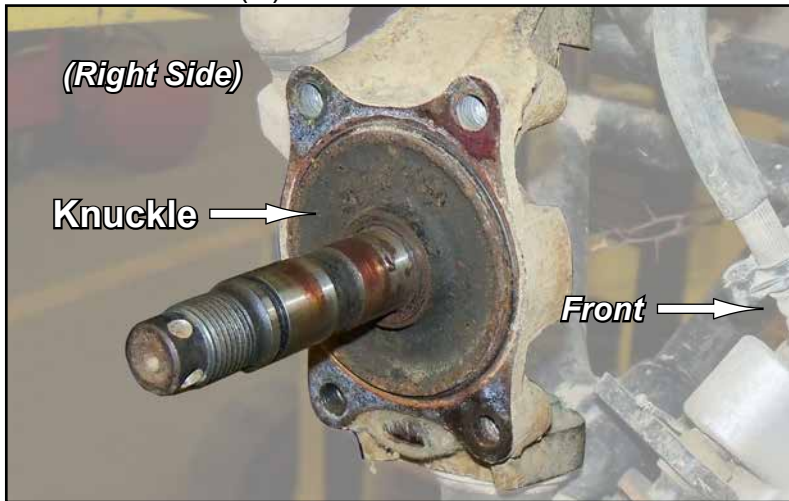

- Install hardware shown and Spacers to Rotor (F).
- Slide Hub onto bolts and install Wheel Spacer (C).
- Tighten hardware completely.

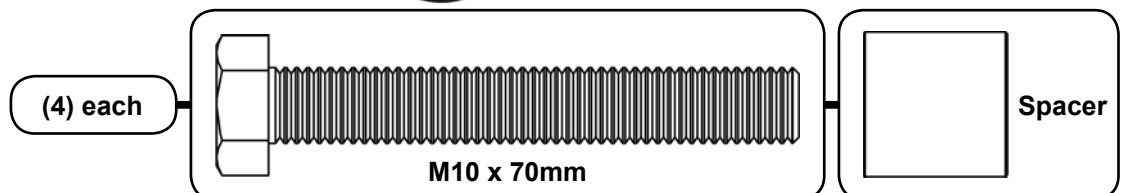
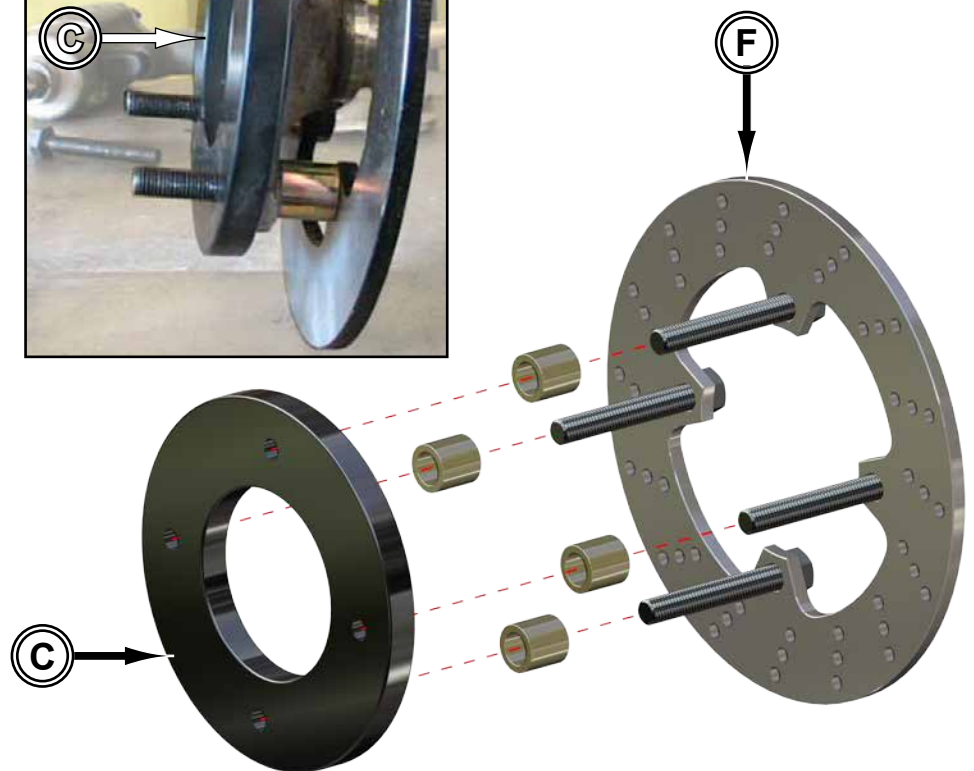
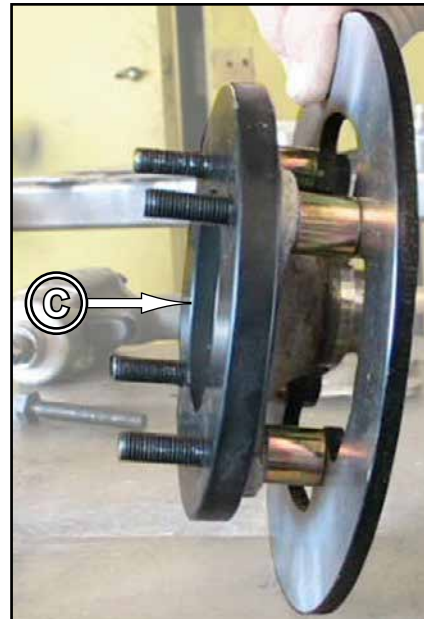

- Install Hub on Axle and reinstall stock Castle Nut and supplied Cotter Pin.

RIGHT

- Place Caliper (B) onto Rotor (F) with Bleeder facing up.
- Secure Caliper (B) to Bracket (D) with hardware shown.
- Brake Hose, in its final position, should cross over Tie Rod End and attach to Caliper (B); some models Brake Hoses will need rerouting. see last page.
- Temporarily reinstall Wheels to check clearance. **Brake Hose must not bind or rub while turning or rotating tires.**

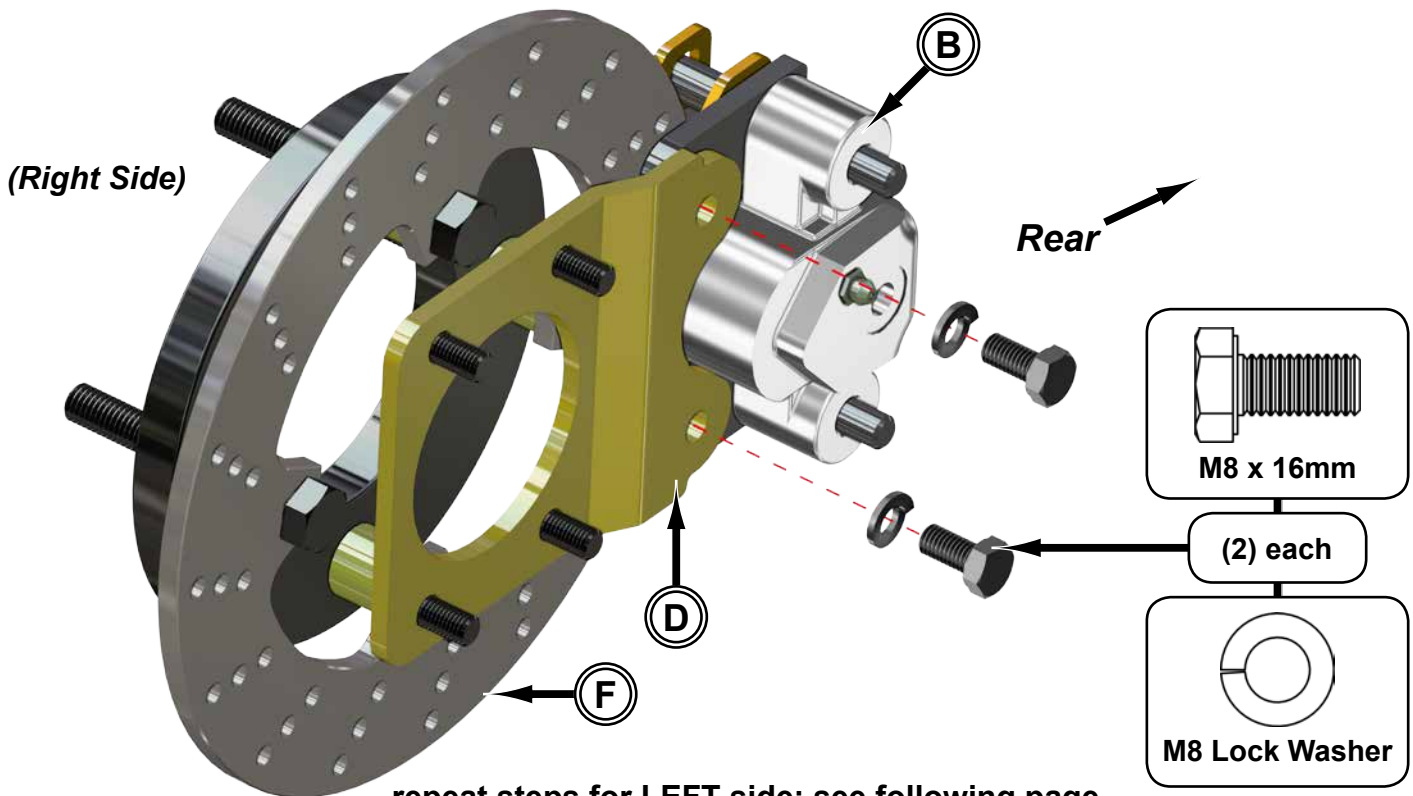
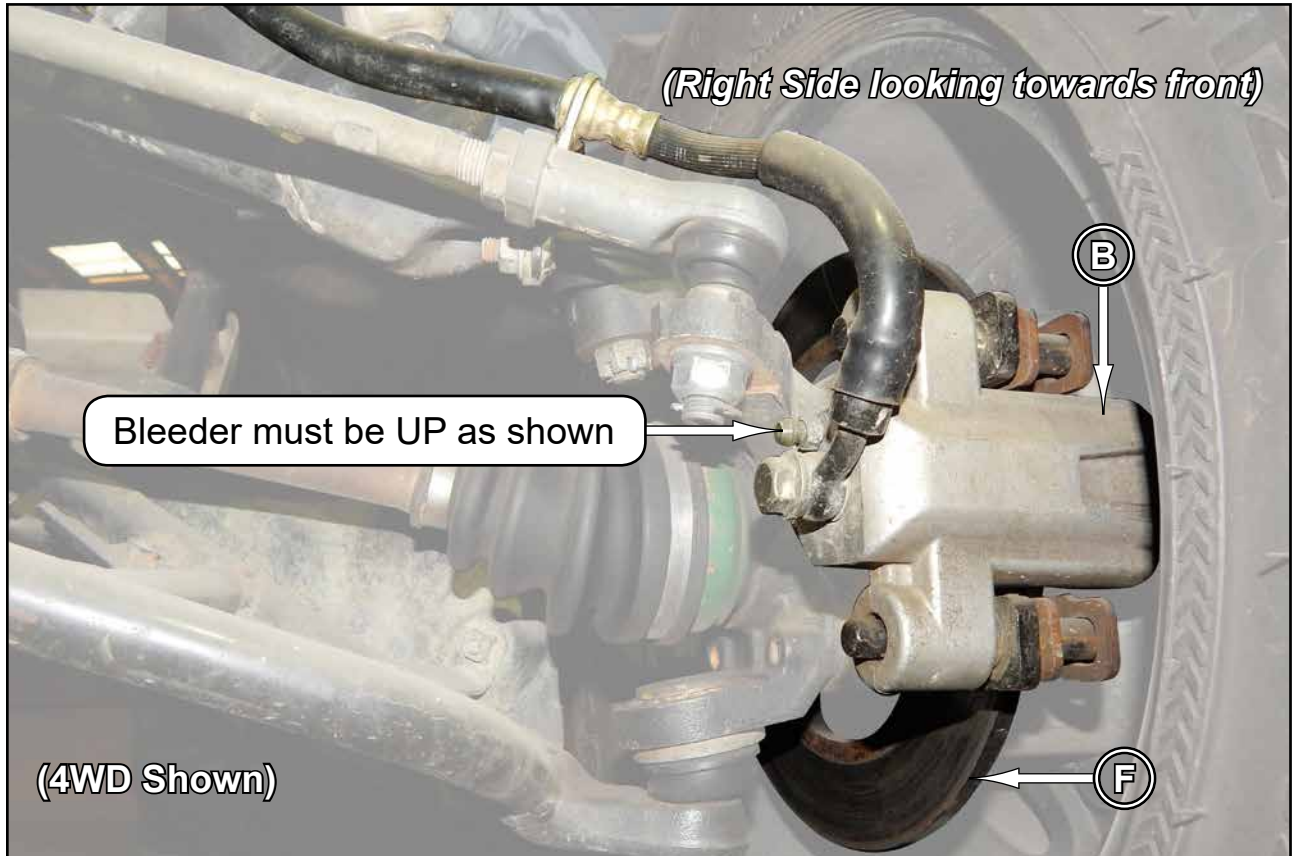

repeat steps for LEFT side; see following page

LEFT

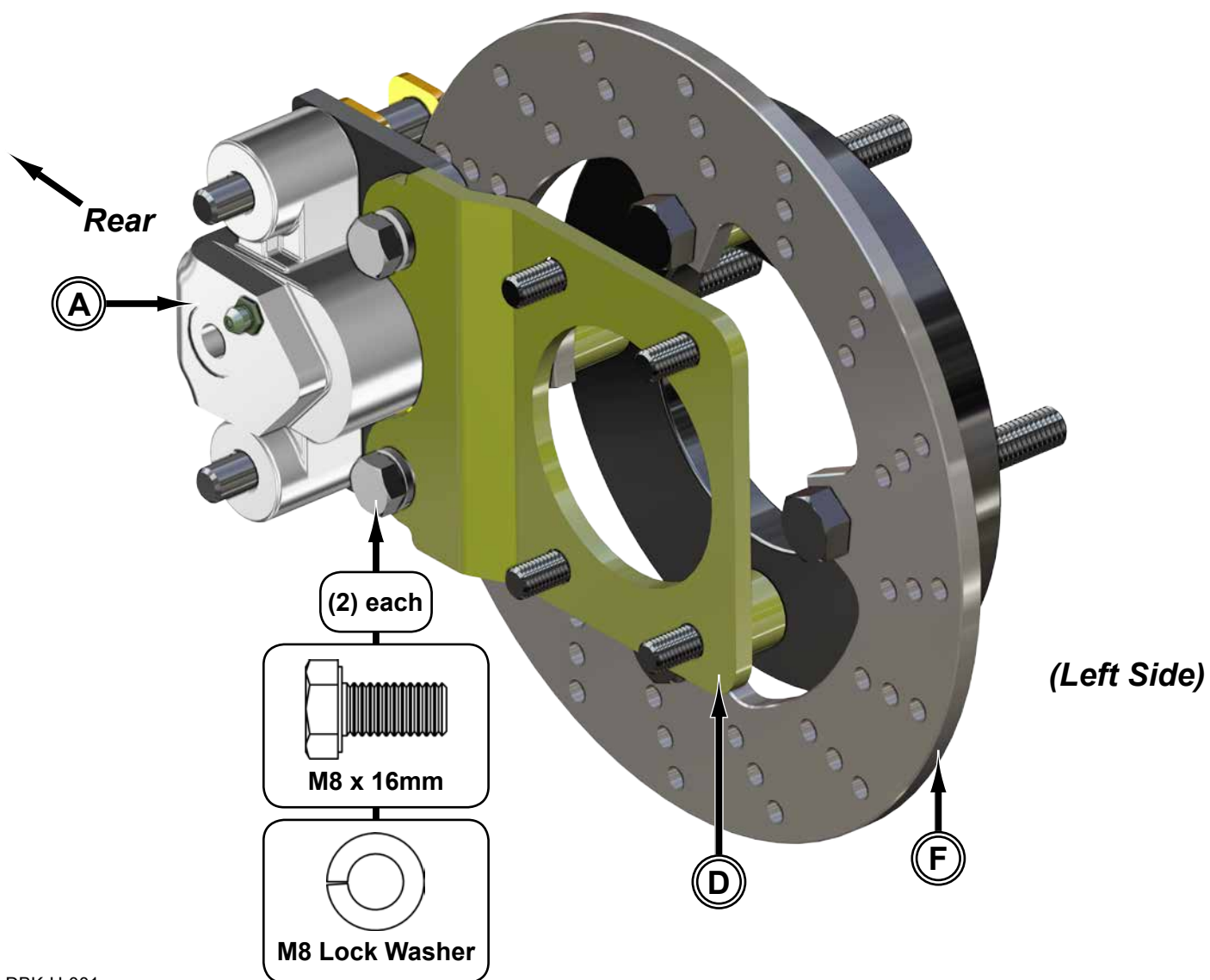

- On some models, Brake Hoses will need rerouting.
- Disconnect stock Brake Hose from outer Mounting Bracket.
- Mount Relocation Bracket (E) using factory hardware at bottom and hardware shown at top.
- Brake Hose, in its final position, should cross over Tie Rod End and attach to Caliper (B).
- Repeat steps for opposite side.

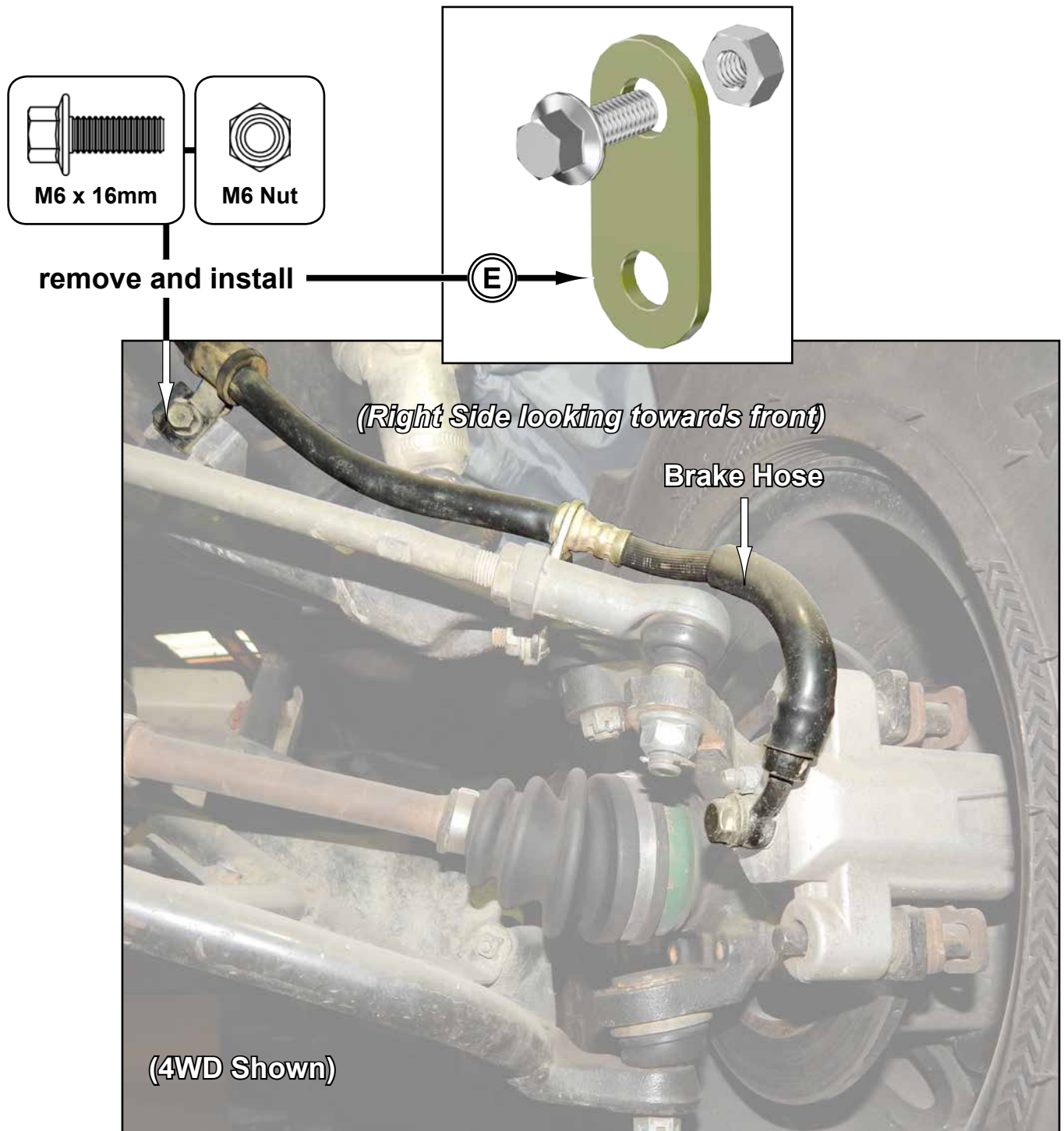

Final:

- Bleed Brakes.
- Seat Brake Pads by test driving and making several hard stops. Allow Brake Pads to cool and perform several more hard stops. If Brakes begin to feel spongy or weak during this time, bleed Brakes again.