

Verify, and adjust if necessary, centering of Rack and Pinion before installing.

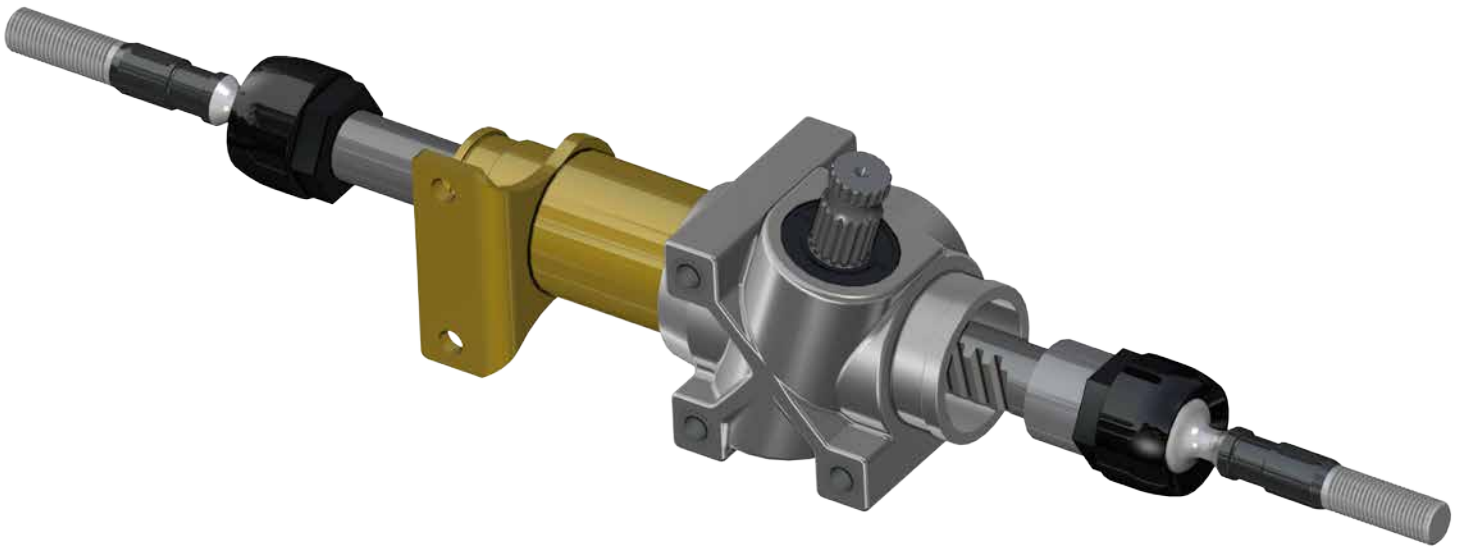

1. Measure distance from inside of Rack and Pinion to face of Tie Rod End.
2. Measure distance from face of Tie Rod End to housing face.
3. Adjust Rack and Pinion until measurements are equal.
- Mark center.

(illustrations on following page)

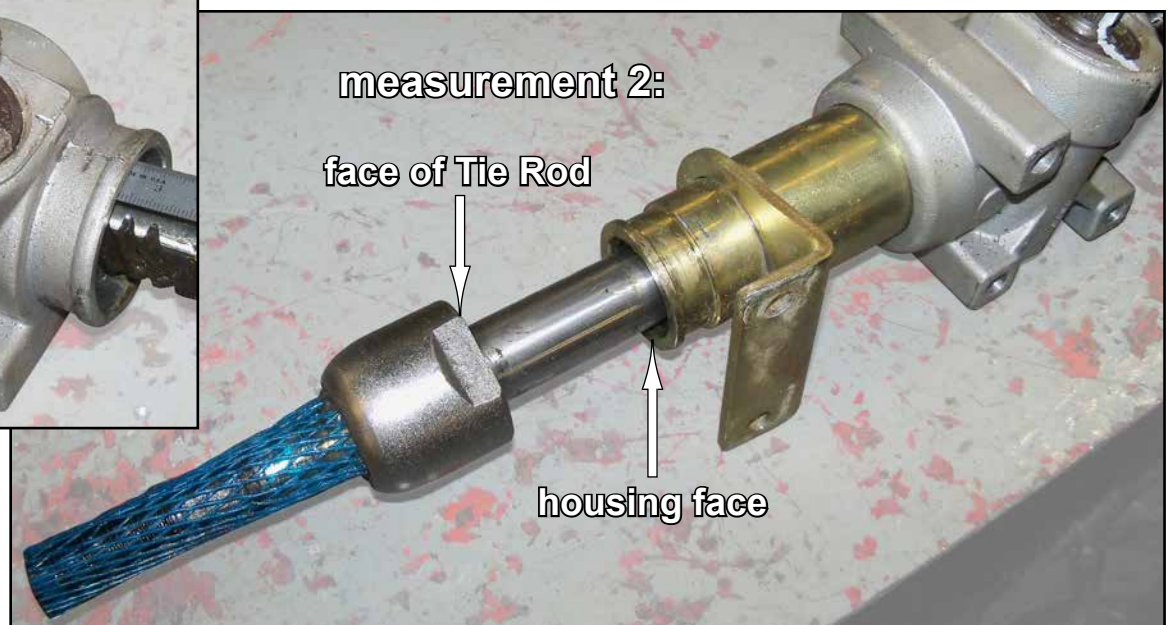
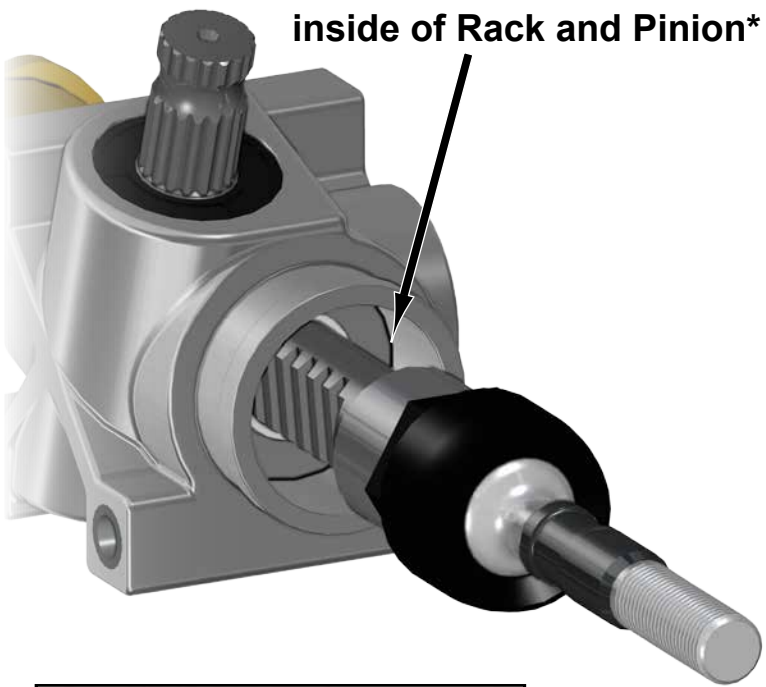
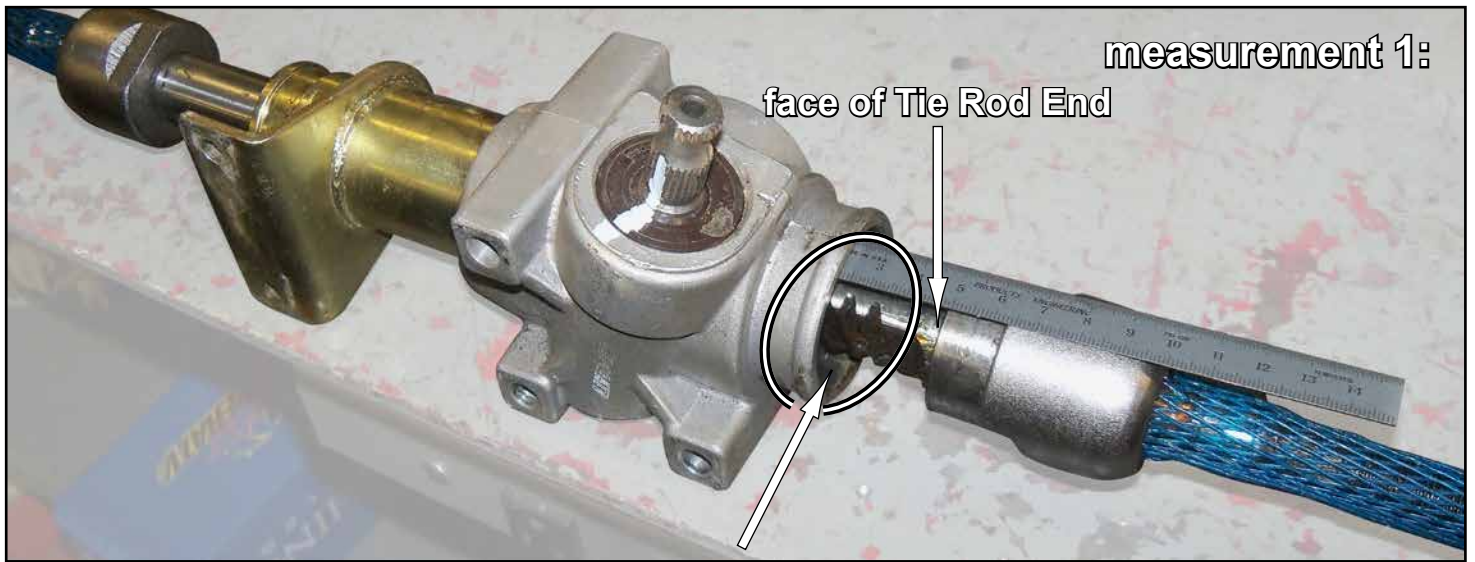

Do not discard packaging until product has been successfully installed.

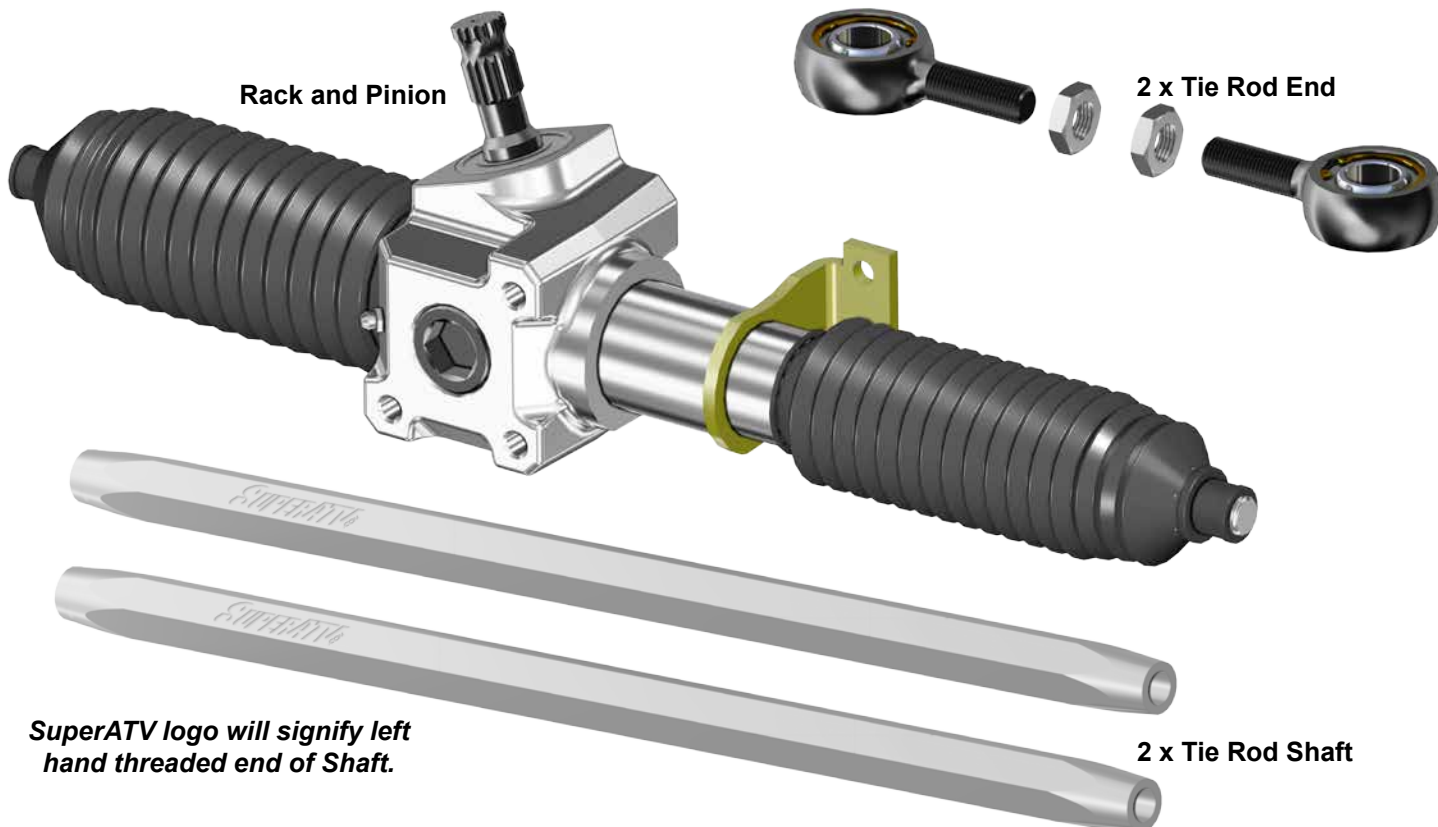

Hardware Kit

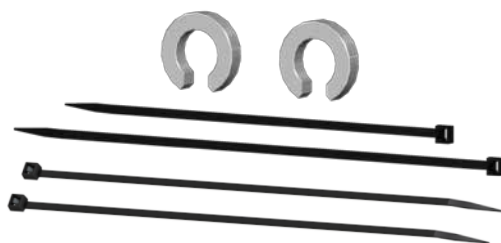

Steering Stop Kit



Hardware Kit

Need help with your installation?



sales@superatv.com



www.superatv.com



1-855-743-3427



8:00am - 8:00pm EST M-Th
8:00am - 7:00pm EST Friday
9:00am - 2:00pm EST Saturday

Read instructions and view illustrations before beginning.

Thank You

For Choosing

SUPERATV.COM[®]

Rack and Pinion Removal: *Keep all hardware and components removed.*

- Raise front of vehicle and secure with jack stands. Remove Wheels.
- Remove (4) Differential Bolts.
- Remove Tie Rods from machine.
- **FROM ONE SIDE ONLY**, remove Shocks from A-Arm, disconnect A-Arms from Spindle, and remove Axle.
- Remove hardware from Lower U-Joint. See Fig. 3.
- Remove hardware from stock Rack and Pinion. See Fig. 3.
- Proceed to "Rack and Pinion Installation".

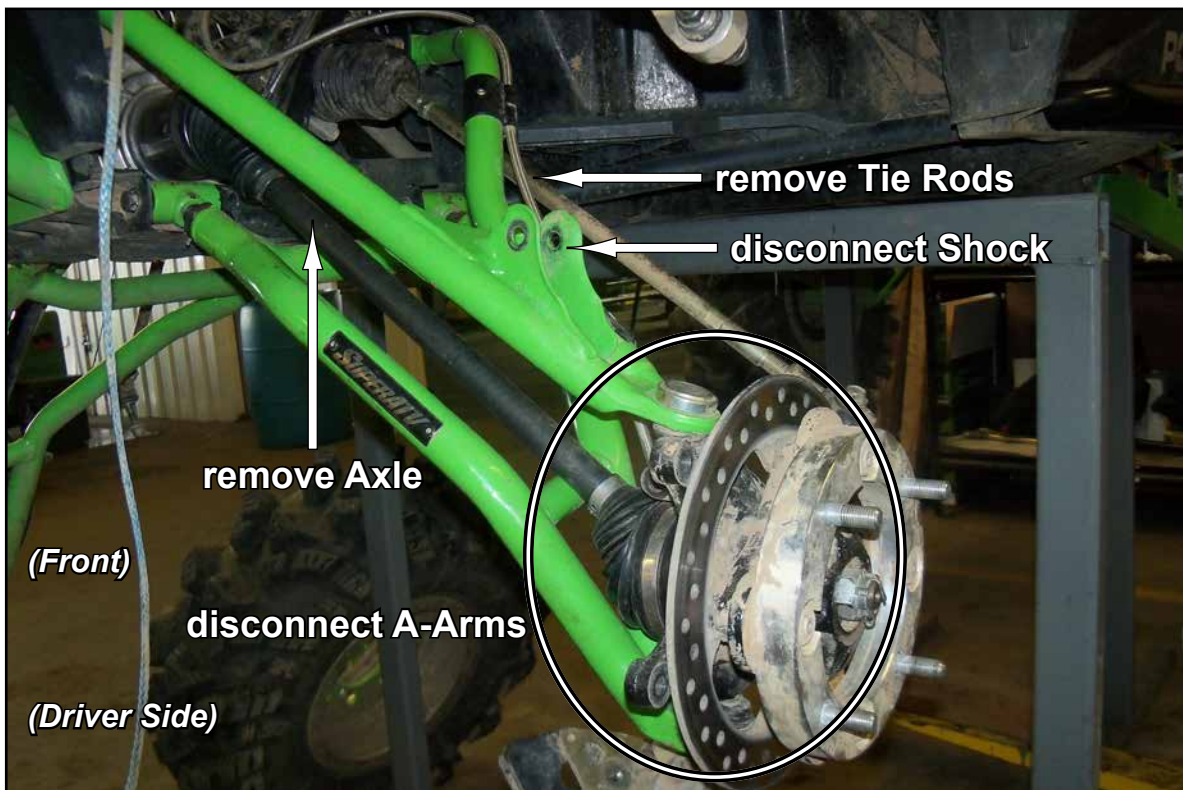
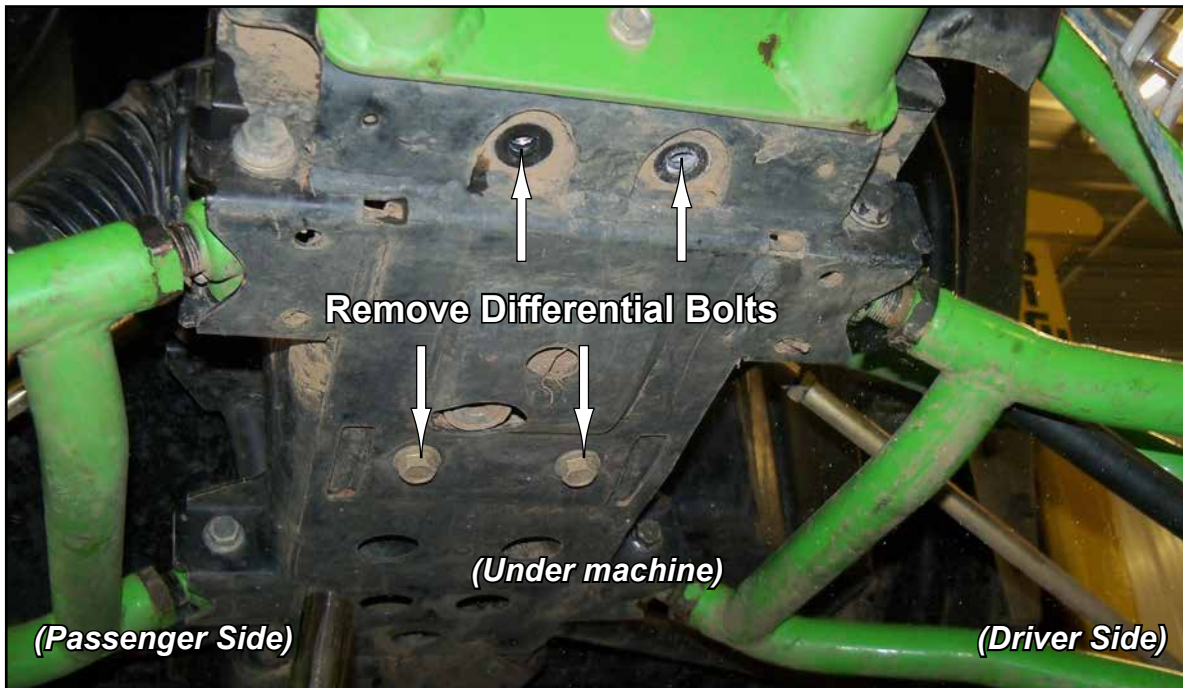

(removal illustrations continue on following page)

Rack and Pinion Removal continued: *Keep all hardware and components removed.*

- Remove hardware from Lower U-Joint.
- Remove hardware from stock Rack and Pinion.
- Proceed to "Rack and Pinion Installation".

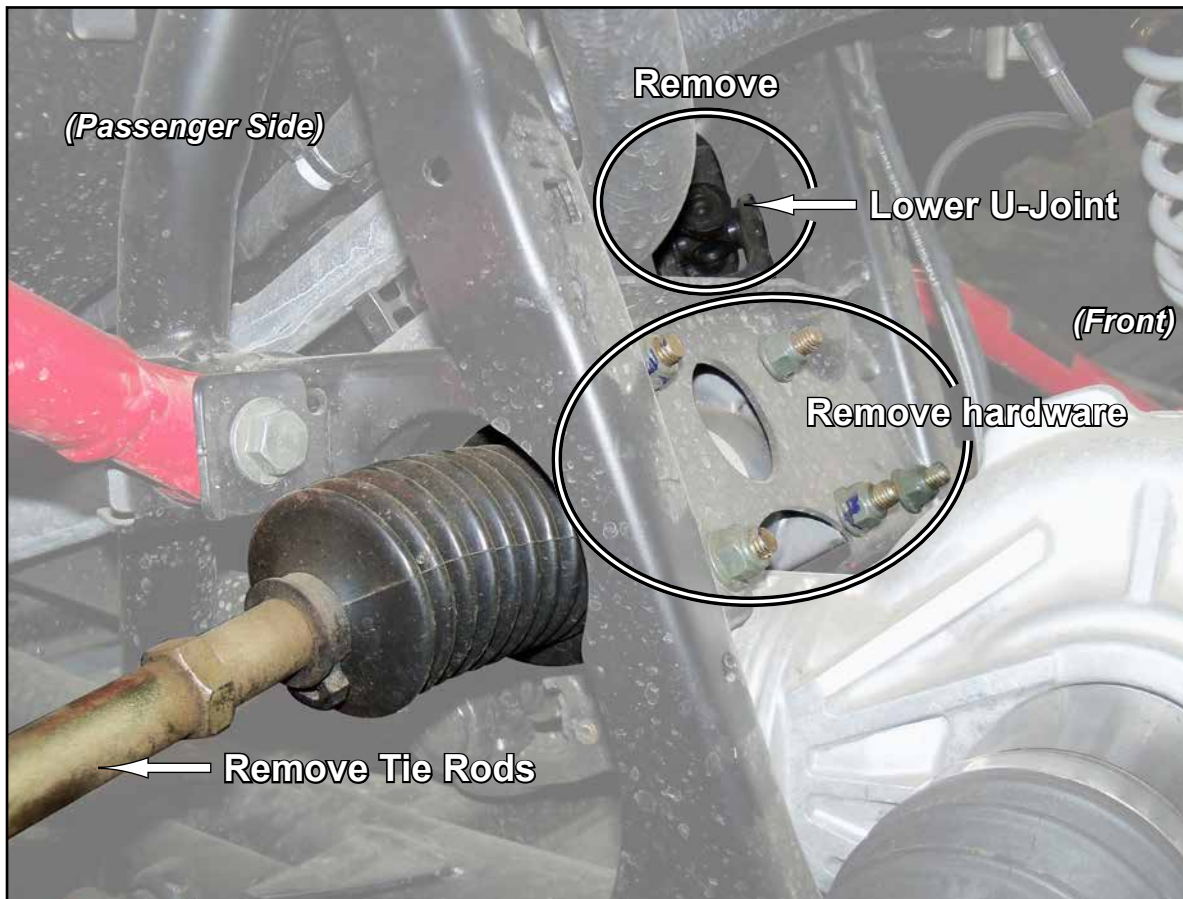

Differential must be pulled and twisted slightly forward before stock Rack and Pinion can be removed from machine.



Steering Stops Installation:

- Unclamp and slide Boot away from Rack and Pinion.
- Install Steering Stop onto Shaft.

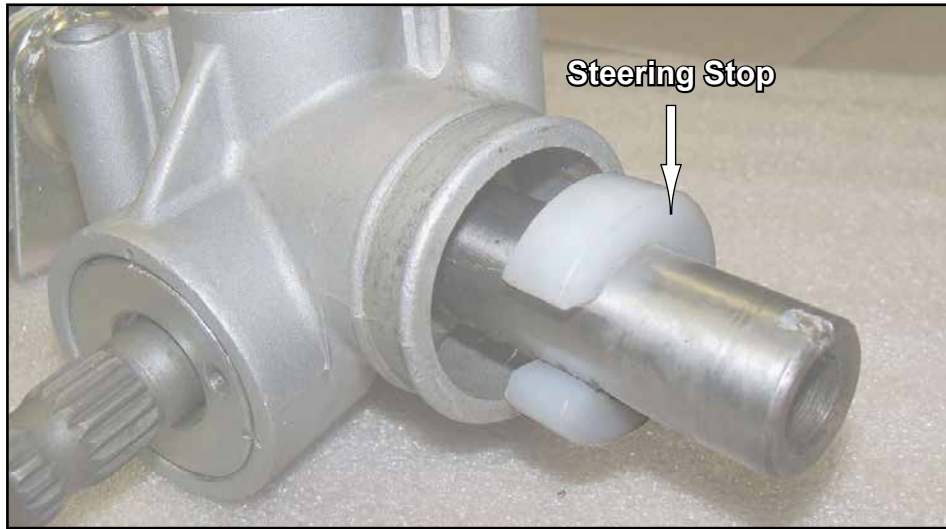

- Resecure Boot with Wire Tie.

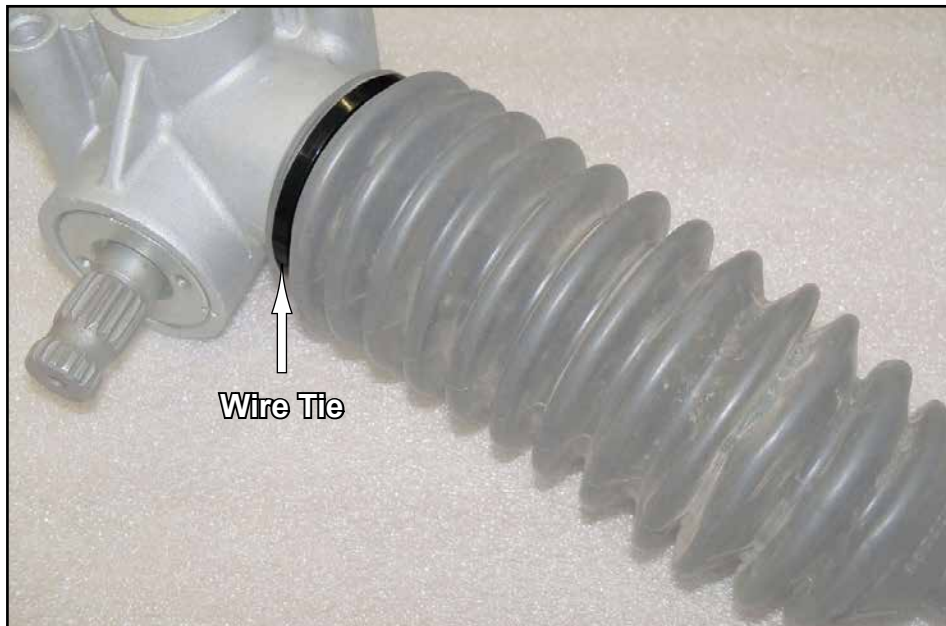

- Repeat steps for opposite Shaft.

Rack and Pinion Installation: *Do not tighten hardware completely unless noted.*

- Install Rack and Pinion to machine with hardware shown.
- Reinstall Steering Shaft to Rack and Pinion with stock hardware.
- Tighten all hardware completely.
- Proceed to "Tie Rod Installation".

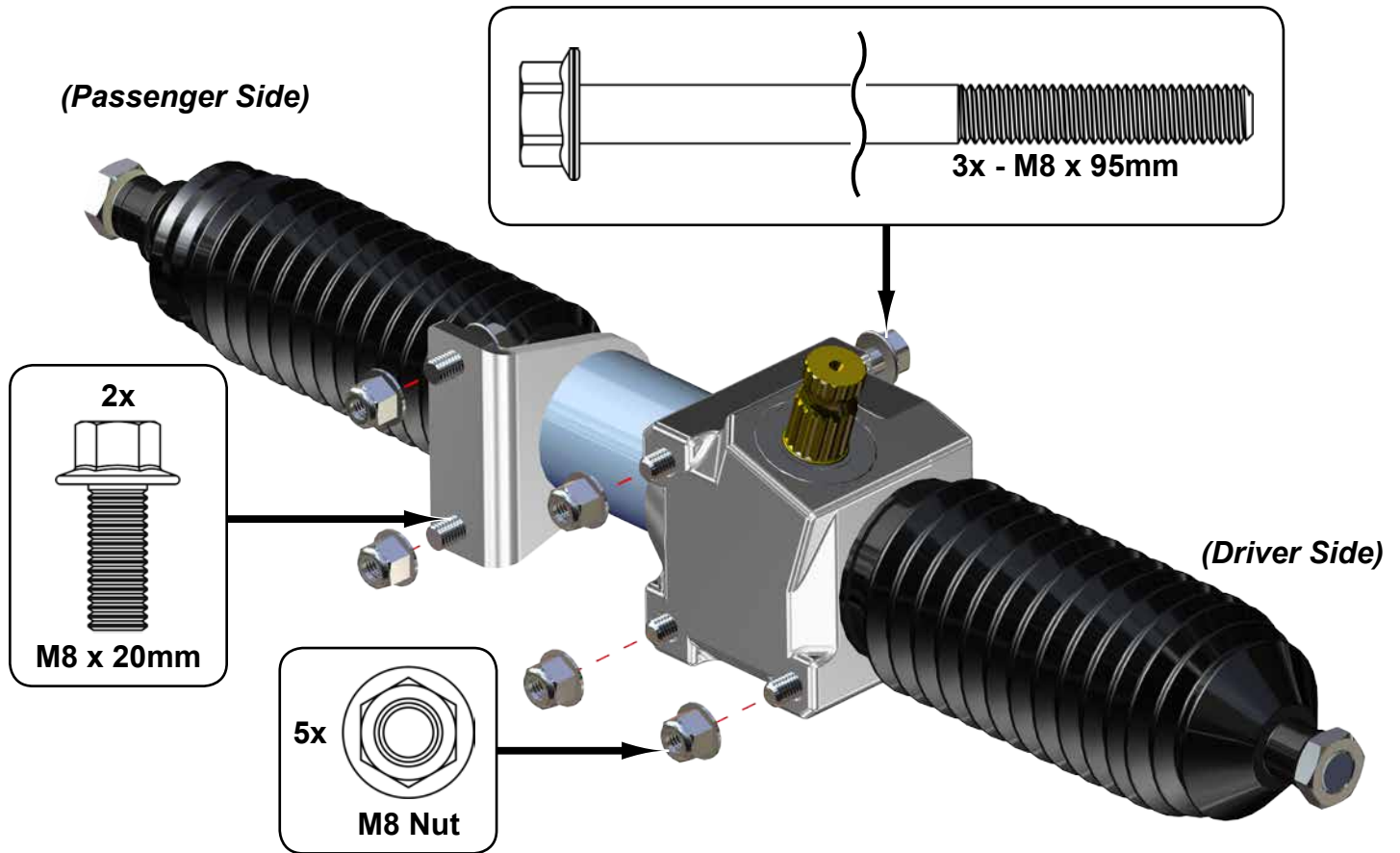

Tie Rod Installation:

- Install Tie Rod Shafts to Ball and Sockets on Rack and Pinion.
- Install Tie Rod Ends to Tie Rod Shafts.
- Secure Tie Rod Ends to same location as stock on Spindles with appropriate hardware.

